

Series 901

Modular Cleanroom Walls

The Series 901 cleanroom walls provide a versatile modular wall system that is designed for high-quality cleanroom performance, ease-of-installation and feature the ability to be relocated or modified without damage to the wall system.

The standard wall panel is constructed of white vinyl-covered steel. The 18 Ga. steel is laminated with textured vinyl on one side and smooth vinyl on the opposite. The panels may be formed with either a smooth or textured finish to the room side. The panels are also available with unpainted zinc finish, smooth or textured baked enamel, epoxy or conductive finishes. The painted panels may be painted to colors other than the standard white.

The construction incorporates bolt fasteners for connecting the panels.

The Series 901 cleanroom walls are available in three standard designs: D200, D150, and D100 wall panels.

Features

- ❖ Modular design
- ❖ Easy, bolt-together design
- ❖ Custom-made sizes and shapes
- ❖ Easy, fast installation
- ❖ Relocatable
- ❖ Cleanroom and pharmacy compatible



For more information or to download or fax this product from the web, simply go to:

www.cleanairproducts.com/901

Series 901 Modular Cleanroom Walls

The 901-D200 double panels have a cleanroom-finished surface on both sides of the wall. The panels are constructed with two halves that are attached together to form a single wall panel concealing the fasteners. This provides a panel with a high-quality cleanroom finish on both sides. The 901-D200 is normally used in areas where a high-quality finish is required on both sides. The one side of the wall is a cover panel and can be removed from the bolted panels to allow utilities to be added or panels removed.

The 901-D150 panel is a single-panel design. This type has a cleanroom finish on one side of the wall. A vertical cover may be used to cover the flange and fasteners where appearance is important.

The 901-D100 wall has a painted cleanroom finish on the unpainted, paintable, zinc-material side. The back side of the panel has a gray, unpainted, exposed panel and bolts. This type of wall panel is commonly used where the back side of the wall is towards a service chase or building wall where it is not visible. A wall may be of the unpainted material and painted after the walls are up.

Doors

The standard doors are steel. Aluminum-framed hinged glass, hinged steel or automatic sliding aluminum frame glass doors can be incorporated into the wall system. The steel doors have a standard finish of white baked-enamel paint and the aluminum glass doors have a clear anodized finish.

The standard window is flush-mount 35.5 in. x 35.5 in. with an aluminum frame and a plexiglas window pane.

Opening sizes are:

35.5 in wide x 35.5 in. high

35.5 in. wide x 48 in. high

84 in. wide x 48 in. high

Options such as scratch-resistant lexan, safety glass or yellow plex are available.

Standard Wall Dimensions

Thicknesses are 4.875 in. and 2.875 in.

Widths of 42 in. wide and narrower

Heights of 120 in. and shorter for vinyl-covered steel; painted steel may be made over 120 in.

Options

- Electrical receptacles
- Return air vents
- Pass thru
- Special cutouts or openings
- Special shapes
- Insulation for heat or sound

Installation Below a Drop Ceiling

The walls are installed by mounting a bottom floor track to the floor and mounting a top track to the under side of the tee bar grid system. The wall panels are then set into place and bolted together.

Installation with No Drop Ceiling

The bottom floor track is attached to the floor. The walls are set into place and the top track is placed on the wall as they are assembled. Wall panels may be removed at any time provided there are not utilities.

Guarantee

A written 1 year warranty is furnished with each wall unit.

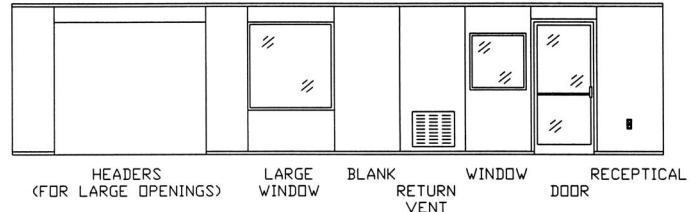
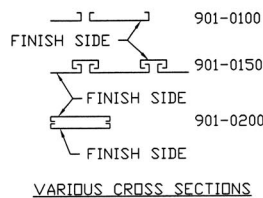
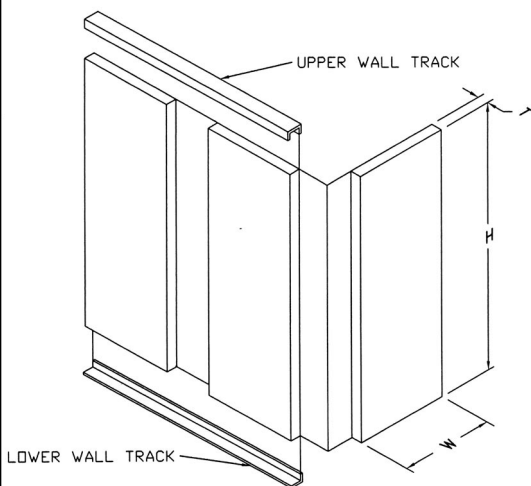

Note:

Standard Wall Thickness:

T = 2 7/8 in. and T = 4 7/8 in.
Others available.

Standard Wall Width:

W = 42 in.
Others available.

Height:

As required under 10 ft.
Over 10 ft. upon request.

Specifications subject to change. Please contact factory for details.

Clean Air
PRODUCTS

Solutions Built to Your Specifications.

8605 Wyoming Ave. N. • Minneapolis MN 55445

tel: 763.425.9122 800.423.9728 fax: 763.425.2004

e-mail: sales@cleanairproducts.com www.cleanairproducts.com